

M3.C6AS_T4

ÁREA TOTAL (M²) 250.4 m²

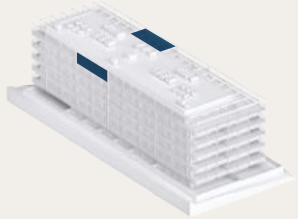

ÁREA BRUTA P. (M ²)	164.1 m ²
ÁREA EXTERIOR (M ²)	82.3 m ²
ESTACIONAMENTO (M ²)	28.6 m ²
ARRECADAÇÕES (M ²)	7.5 m ²

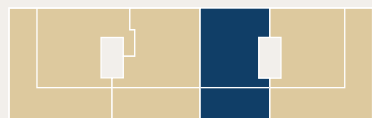

PISO 6



0 1 2m

